

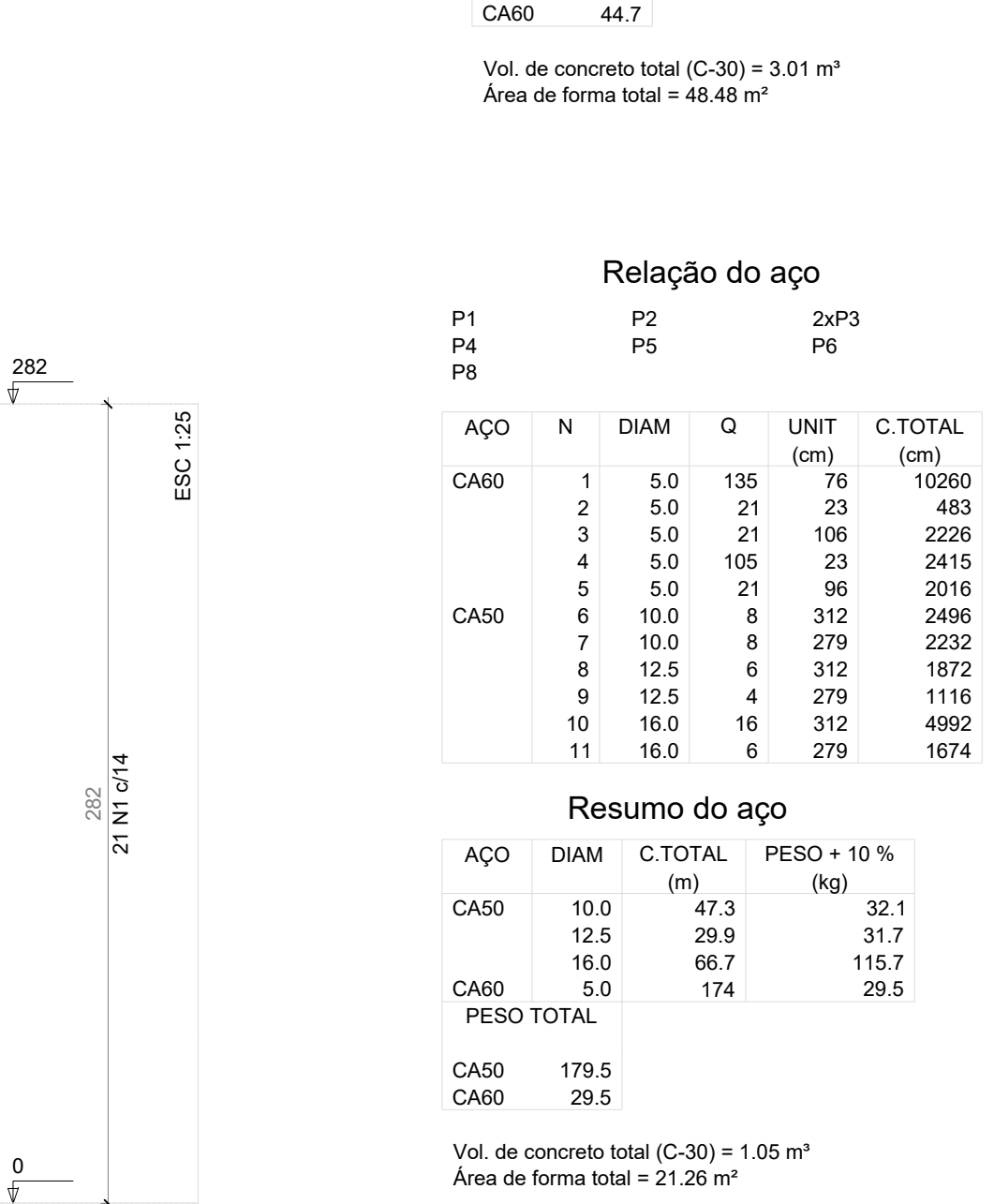

100



Vol. de concreto total (C-30) = 1.79 m<sup>3</sup>



DIAM	C.TOTAL (m)	PESO + 10 % (kg)
10,0	47,3	32,1
12,5	29,9	31,7
16,0	66,7	115,7
5,0	174	29,5
<b>SUB TOTAL</b>		
	179,5	
	29,5	

de concreto total (C-30) = 1,05 m³  
de forma total = 21,26 m²

EST. BANGKOK INDUSTRIAL ZONE